

### In the Box

- (4) Wheel Stop Parts
- Hardware Bag
- Wheel Saver
- Strap

### Tools Required

- 1/2" Wrench
- 3/16" Allen Wrench (Included)

### DRIVER SIDE



### PASSENGER SIDE

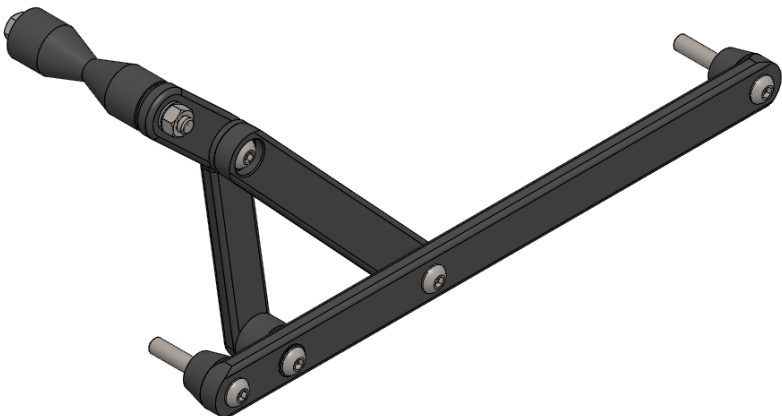

# Assembly

(Use exploded views for reference and part orientation)

## Driver Side

(Shown on left side)

## Passenger Side

(Shown on right side)

- Attach Spool to Pivot Arm using 5/16-18 x 4" hex bolt, washers, and nut. Install in clearance hole. Tighten firmly.

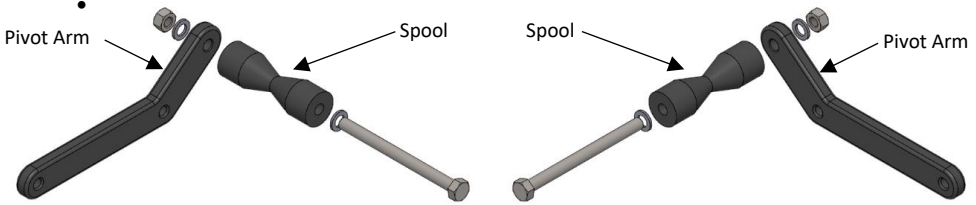

- Place .625" OD x .031" thick plastic washer on threads of 5/16-18 x 3/4" button head and insert into counterbore of Brace Arm.
- Place 1" OD x 1/8" thick spacer on button head and thread assembly into middle hole on Pivot Arm, opposite side as Spool. Tighten until joint is stiff to rotate.



- Place .625" OD x .031" thick plastic washer on threads of 5/16-18 x 1 1/4" button head and insert into hole shown below in Spanner Arm, opposite side as Flange.
- Place 1" OD x 1/2" thick spacer onto button head and thread assembly into last hole on Pivot Arm, same side as Brace Arm. Tighten until joint is stiff to rotate.

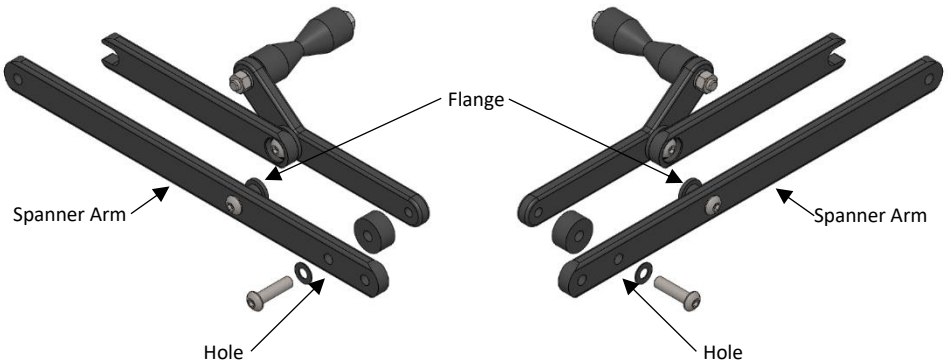

## Installation

(Driver side shown. Passenger side will install same way.)

- Use 3/16" Allen and 1/2" Wrench to remove hardware holding Blue Lever to 15 Degree Plate.
  - Pay attention to location of plastic washers. Plastic washers will be reinstalled in original location when installing Wheel Stop.
- Install Wheel Stop using photo below for orientation and order of hardware.
- Tighten Nylock Nut until Blue Lever is stiff to rotate.
- 

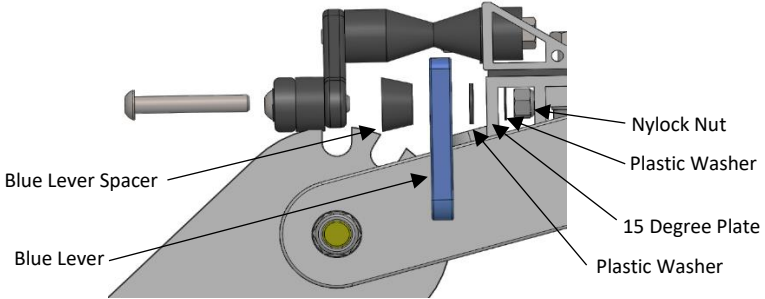

## Using Wheel Stop

- Lift on Wheel Stop Spool.
- Brace Arm will engage around Flange when in use.
- Place bike on rack with front wheel against Spool of Wheel Stop.
- Bent Arm operates as normal on front wheel.
- Bent Arm for rear wheel will not press against rear tire but will hover over rear fender.
- Strap must be used to secure rear wheel to tray.
- For use with road bikes, use Wheel Saver on Spool of Wheel Stop.

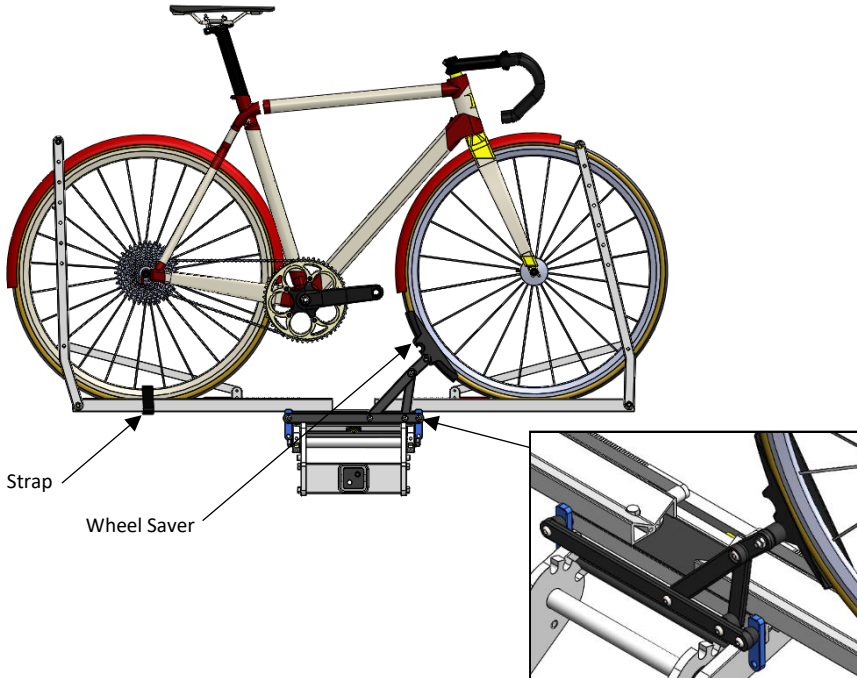

## Storing Wheel Stop

- Move Wheel Stop Spool away from center of rack and disengage Brace Arm from Flange.
- Straighten Brace Arm in line with Pivot Arm.
- Rotate Brace Arm and Pivot Arm down to lay flat on 15 Degree Plate.

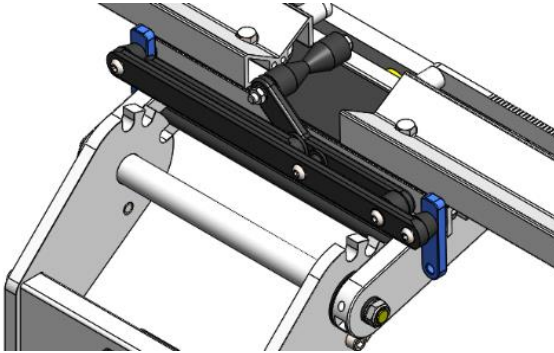

## Additional Instructions

- Remove road debris off nuts and bolts to prevent corrosion.
- Inspect hardware on Accessory periodically to ensure proper working conditions.
- Certain car wash chemicals may damage Accessory finish. Please use caution when cleaning vehicle and/or Accessory.

Questions or comments? Contact our support team via email at [email@1up-usa.com](mailto:email@1up-usa.com)