



## V Style Ramp Long

### In the Box:

- (1) – Ramp
- (2) – Ramp Hooks
- (4) – 5/16-18 x .625" Button Head
- (6) – .562" OD x .062 Thick Metal FW
- (2) – 1/2-13 x 2.75" Socket Head
- (1) – 5/16-18 x 5" Hex Bolt
- (2) – 1" OD x .312" x .25" Thick Black Plastic Spacer
- (5) – 5/16-18 Jam Nylok Nut
- (1) – Quick Release Pin
- (1) – 3/8 x 5" Spring Pin
- (2) – Ramp Spacer

### Tools Required:

- Security Wrench
- 1/2" Wrench
- 3/16" Allen Wrench

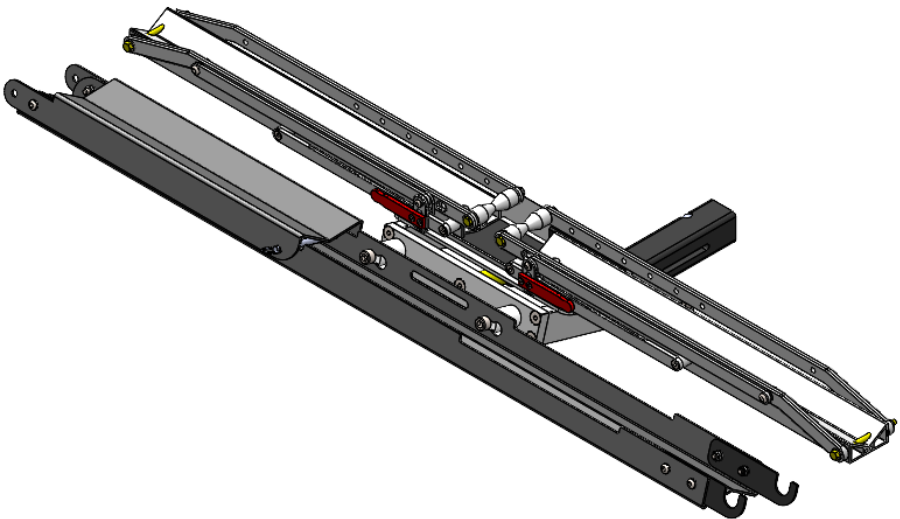

### Product Notes:

- Compatible with Quik Rack, Heavy Duty, Super Duty, and XD Racks.
- Unit can install on driver or passenger side tray.
- Security Wrench required for assembly.
- Unit can be used opened or closed.

# Assembly

- 1. Insert Button Head through Ramp and Ramp Hook. (Ramp Hook to be on inside of Ramp.)
- 2. Install Metal Washer and Jam Nylok Nut onto Button Head. Use 3/16" Allen Wrench and 1/2" wrench to tighten.
- 3. Repeat steps 1-3 for remaining holes.
- 4. Insert Spring Pin through Ramp holes.

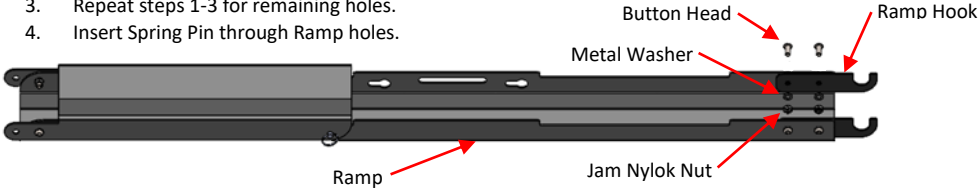

## Closed



## Open



# Installation

## Step 1

Start Socket Heads through Ramp Spacers into Tap Plate threaded holes.

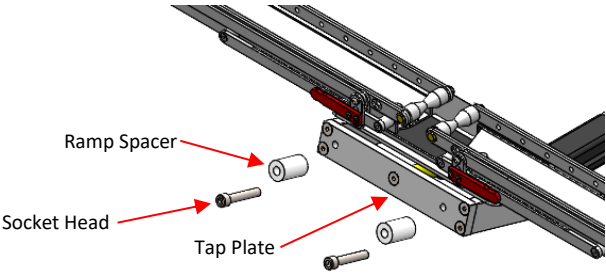

Place closed V Style Ramp Long onto base rack by aligning keyhole slots with Security Bolts. Tighten Security Bolts.

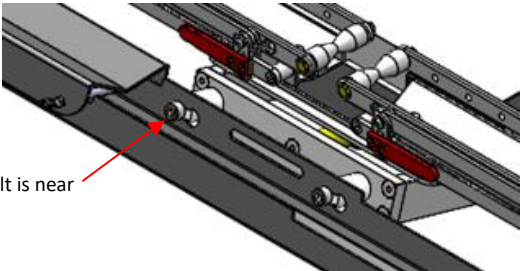

**Step 2**

Use 3/16" Allen Wrench and 1/2" Wrench to remove nut and bolt holding Strap to Bent Arm.

**XD Rack: Omit Step 2**

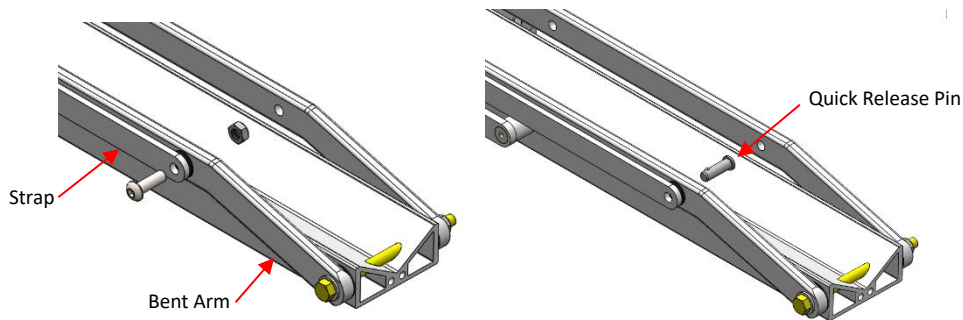

Install Quick Release Pin through Bent Arm, Spacer, and Strap.

**Step 3**

Remove 5/16-18 x 4.5" Hex Bolt from end of Tray. Install provided hardware in sequence shown below.

**Note: Omit Step 3 for bike spots with fat tire spacer kits installed. (Ramp clips onto fat tire spacers.)**

**XD Rack: Omit Step 3 (Ramp clips onto Bent Arm Bracket Spacer)**

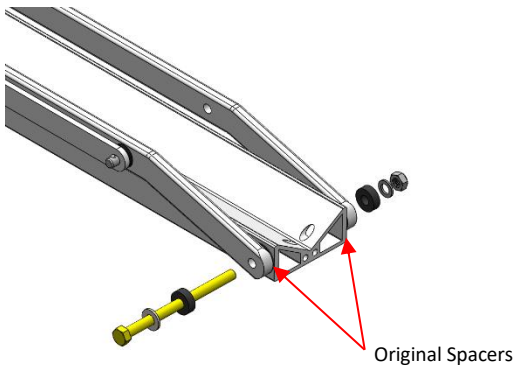

**Loading Ramp**

**Step 1**

Depress spring loaded release on Quick Release Pin and remove Strap from Pin. Pin will remain in bent arm.

**XD Rack: Omit Step 1**

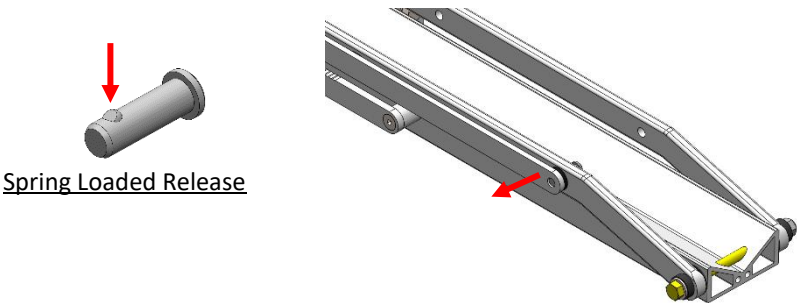

## Step 2

Rotate Bent Arms so Spool is near ground. Remove Spring Pin and open Ramp. Insert Spring Pin into open position hole and clip Ramp onto Spacers (See below).

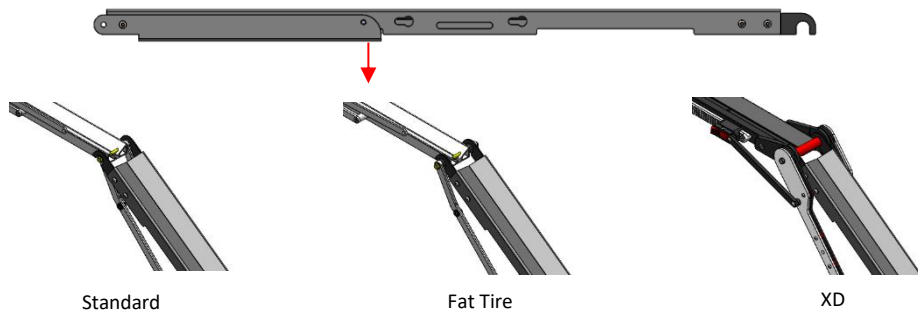

## Step 3

Roll Bike up V Style Ramp Long and onto Rack Trays. Use Bent Arm, opposite of ramp, to stabilize bike while loading.



## Step 4

Remove Spring Pin and close Ramp. Insert Spring Pin into closed position hole and install Ramp onto Tap Plate. If applicable reinstall Strap and Quick Release Pin. Pivot bent arms into tires firmly to secure bike.



### Additional Instructions

- Remove road debris off nuts and bolts to prevent corrosion.
- Inspect hardware on Accessory periodically to ensure proper working conditions.
- Certain car wash chemicals may damage Accessory finish. Please use caution when cleaning vehicle and/or Accessory.

Questions or comments? Contact our support team via email at [email@1up-usa.com](mailto:email@1up-usa.com)