

### Parts List:

- 1) Pin
- 2) Bolt Guard Fixed Block
- 3) Flathead
- 4) Bolt Guard Nut
- 5) Bolt Guard Slide Block
- 6) Lock Coupler

### Tools Required:

- 5/32" Allen Wrench (Included)

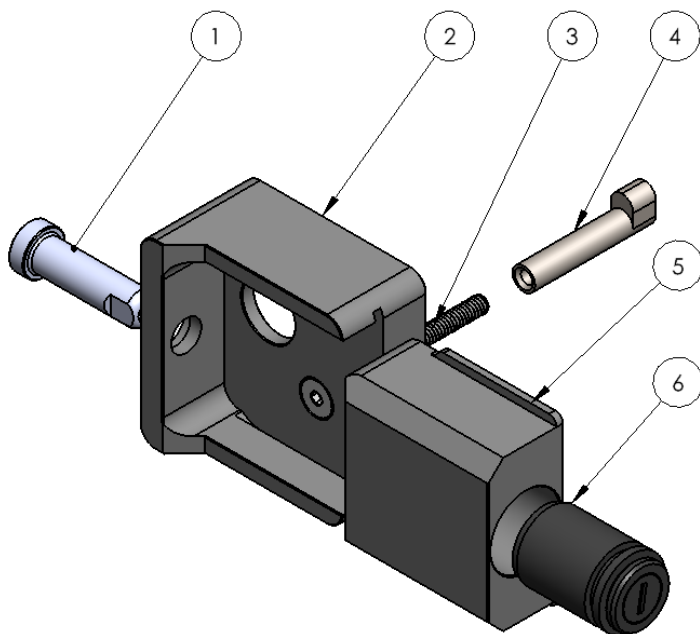

### Product Notes:

- Compatible with Heavy Duty, Super Duty, Xtreme Duty, and Cargo Carriers
- Not compatible with 2.5" hitch bars

## **Bolt Guard Installation**

### **Step 1:**

- Slide Bolt Guard Nut into slot in Hitch Bar, ensuring threaded portion drops down into slot.
- Push Bolt Guard Nut towards Trays until it bottoms out.

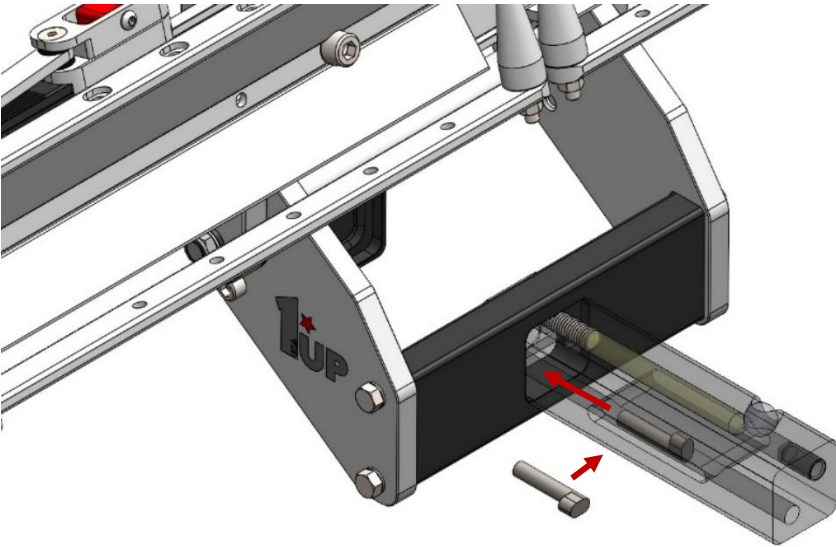

### **Step 2:**

- After removing Bolt Guard assembly from foam packaging, while holding pressure on Pin to prevent rotation, insert key and rotate counterclockwise to disassemble Bolt Guard.
- Align Bolt Guard Fixed Block, ensuring Security Bolt aligns with large hole.
- Install 1/4-20 x 2.75" Flat Head through lower hole in Bolt Guard Fixed Block, threading into Bolt Guard Nut. Use included 5/32" Allen Wrench to tighten.
- If Bolt Guard Nut slides back in Hitch Bar, 3/8" Rack Wrench can be utilized to hold Bolt Guard Nut in forward position while starting 1/4-20 x 2.75" Flat Head.

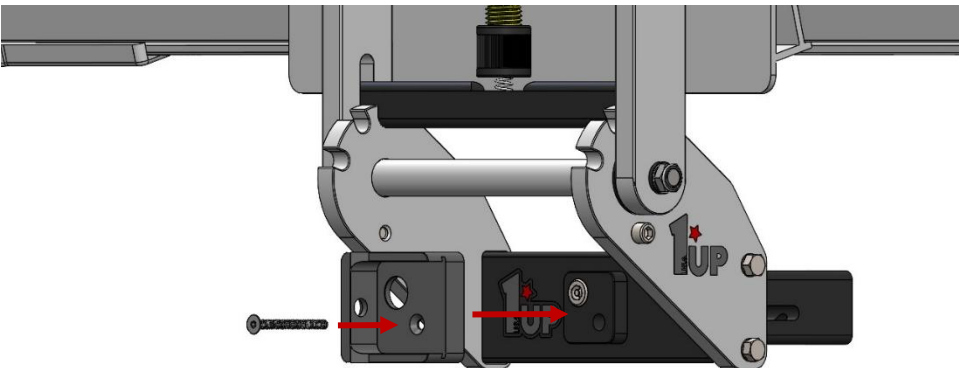

## Using Bolt Guard

### Step 1:

- Install rack into vehicle receiver and tighten Security Bolt.
- Align Bolt Guard Slide Block with Bolt Guard Fixed Block and slide blocks together, ensuring large hole is on passenger side.

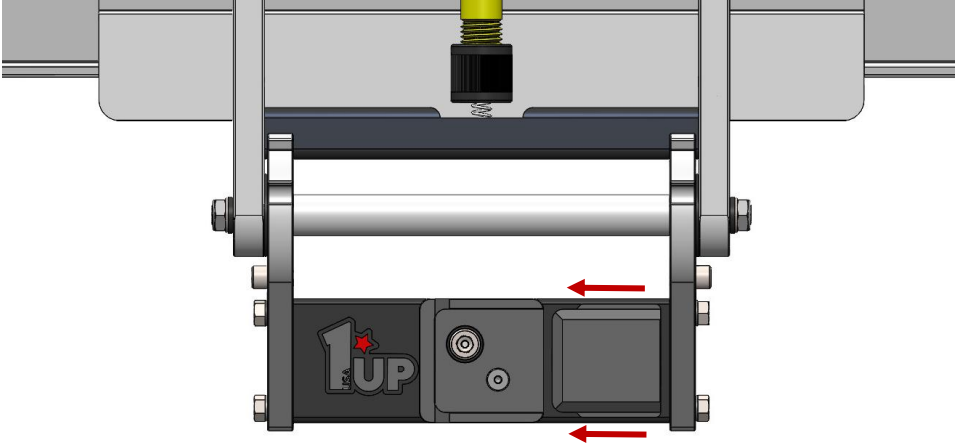

### Step 2:

- Align Bolt Guard Pin with Bolt Guard Fixed Block and insert from driver side.

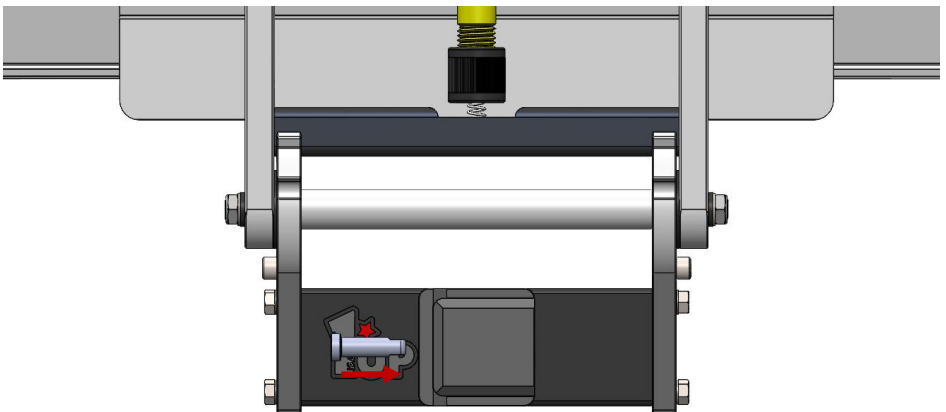

### **Step 3:**

- Align Lock Coupler with Pin and tighten by turning key clockwise while holding pressure on Pin to prevent rotation.
- To remove key after locking, while holding pressure on Pin and gently pulling on key, rotate counterclockwise until key releases.

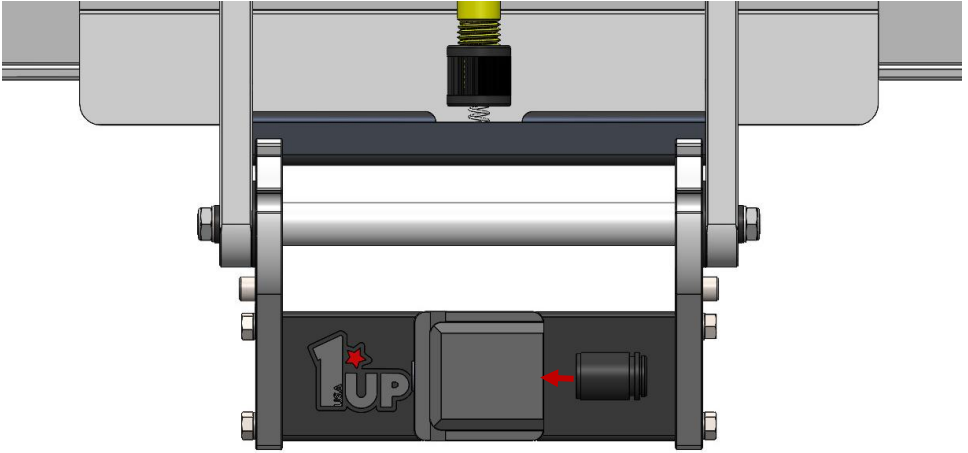

### **Additional Instructions**

- Record key number for future reference in event keys become lost.
- Remove road debris off nuts and bolts to prevent corrosion.
- Inspect hardware on Accessory periodically to ensure proper working conditions.
- Certain car wash chemicals may damage Accessory finish. Please use caution when cleaning vehicle and/or Accessory.

Questions or comments? Contact our support team via email at [email@1up-usa.com](mailto:email@1up-usa.com)